

Pos.	Ø _c [mm]	h [mm]	s [mm]	ρ _v [%]	ρ _l [%]	Masse [kg]
1	300	16	3.30	24	61.12	131.50
2	217	16	7.17	24	172.00	278.94
3	214	16	7.44	24	178.56	289.65
4	Ø	8	1.00	664	1089.52	445.30
5	Ø	16	6.90	144	1000.80	1622.30
6	Ø	16	8.15	24	79.80	122.85
7	Ø	16	6.90	24	152.40	247.04
8	Ø	8	6.17	444	2738.40	1120.60
9	Ø	8	2.97	632	1877.04	747.71
10	Ø	8	4.12	28	115.36	47.18
11	Ø	8	3.17	90	253.60	103.72
12	Ø	8	4.04	90	323.20	132.19
13	Ø	8	3.60	700	2489.00	1016.96
14	Ø	8	3.36	80	271.20	110.80
15	Ø	8	3.07	28	85.84	35.14
16	Ø	8	2.97	196	982.12	238.09
17	Ø	8	1.84	26	61.52	21.07
18	Ø	8	3.05	90	181.80	61.94
19	Ø	8	6.10	24	105.84	65.43
20	Ø	8	2.10	30	67.20	27.48
21	Ø	8	1.80	256	408.00	167.55
Σ						
1	Ø	12	11.42	2	22.86	21.05
2	Ø	12	6.00	2	12.00	11.10
3	Ø	12	8.90	4	35.60	32.76
4	Ø	12	4.10	4	16.40	15.38
5	Ø	12	4.14	4	16.56	15.34
6	Ø	10	5.80	40	232.00	100.57
7	Ø	10	5.90	26	153.40	69.94
8	Ø	14	6.05	8	54.45	68.17
9	Ø	14	11.90	16	188.40	230.37
10	Ø	14	8.90	34	302.60	378.84
11	Ø	14	3.90	12	46.80	58.59
12	Ø	14	3.60	12	46.32	57.95
13	Ø	14	5.90	6	53.10	66.48
14	Ø	14	6.10	12	73.20	91.85
15	Ø	14	3.86	6	23.16	28.00
16	Ø	14	3.90	6	23.16	28.00
17	Ø	14	3.57	3	10.71	13.41
18	Ø	14	3.90	3	10.66	13.37
19	Ø	14	3.36	3	10.14	12.70
20	Ø	14	3.48	3	10.44	13.07
21	Ø	12	3.00	2	6.00	5.52
22	Ø	12	3.10	2	6.20	5.70
23	Ø	14	6.12	4	24.48	30.85
24	Ø	14	12.18	4	48.72	61.06
25	Ø	10	4.54	2	9.08	5.88
26	Ø	10	5.14	2	10.28	6.87
27	Ø	10	1.62	1147	1858.14	1265.85
28	Ø	10	5.65	13	73.30	45.84
29	Ø	10	5.78	3	17.37	15.94
30	Ø	14	6.20	4	24.80	31.06
31	Ø	10	3.06	78	238.68	164.90
32	Ø	14	6.98	1	5.98	7.34
33	Ø	14	6.10	2	12.20	15.27
34	Ø	12	3.50	2	7.00	6.44
35	Ø	12	3.60	2	7.20	6.62
36	Ø	14	3.40	40	136.00	170.27
37	Ø	14	3.60	12	43.20	54.09
38	Ø	14	3.10	4	12.40	15.78
Σ						
Σ						10352.31

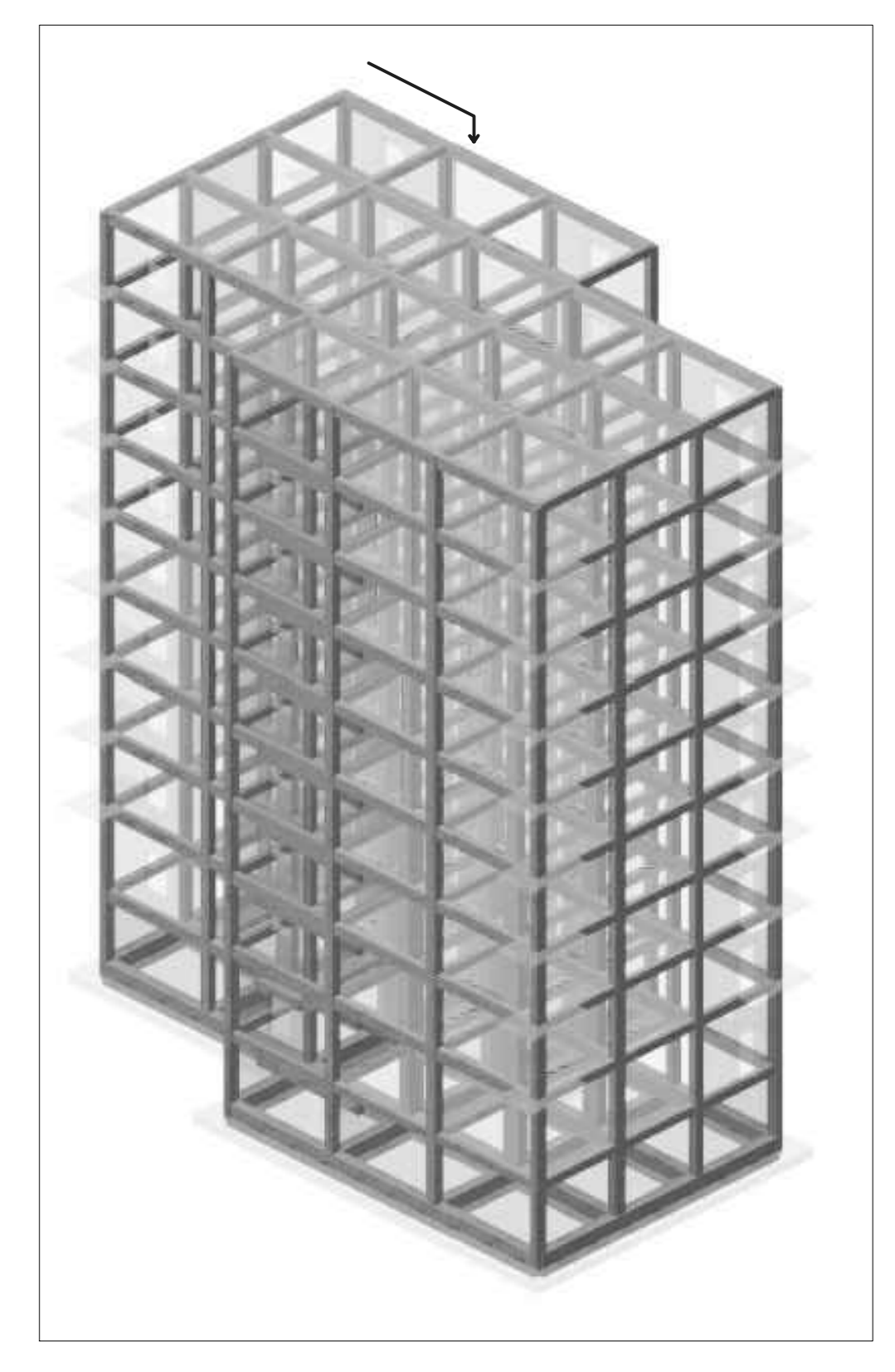

Index	Datum	Änderung	Gezeichnet